

### Soils Map

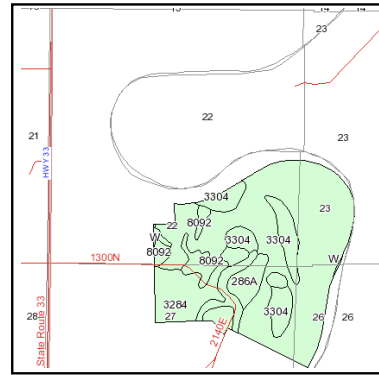

State: **Illinois**  
 County: **Lawrence**  
 Location: **022-004N-010W**  
 Township: **Russell**  
 Acres: **289.2**



Fsa borders provided by the Farm Service Agency as of May 23, 2008.  
 Soils data provided by USDA and NRCS.  
 PLSS provided by Illinois State Geological Survey.

Code	Soil Description	Acres	Percent of field	Non-Irr Class	Bromegrass alfalfa	Bromegrass alfalfa hay	Corn	Grass legume hay	Grass legume pasture	Orchardgrass alfalfa hay	Smooth bromegrass	Soybeans	Winter wheat
3306	Allison silty clay loam, frequently flooded	174.3	60.3%	IIw	6.7		149	5.6	8.2	4		47	
3304	Landes fine sandy loam, frequently flooded	35	12.1%	IIIw	4.1	2.5	109	2.8	4			37	
3284	Tice silty clay loam, frequently flooded	29	10.0%	Vw	6.9		149	4.6	6.8	4.1		46	
8092	Sarpy sand, occasionally flooded	20.8	7.2%	IVs		0.9	100	3.4	5		1.8	34	37
286A	Carmi sandy loam, 0 to 2 percent slopes	17.2	5.9%	IIs	7.2		131	3.8	5.7	4.3		40	54
286B	Carmi sandy loam, 2 to 4 percent slopes	11.4	3.9%	IIe	7.1		130	3.8	5.6	4.3		40	53
W	Water	1.5	0.5%										
<b>Weighted Average</b>					<b>5.9</b>	<b>0.4</b>	<b>137.9</b>	<b>4.8</b>	<b>7</b>	<b>3.2</b>	<b>0.1</b>	<b>43.8</b>	<b>7.9</b>