

Soils Map

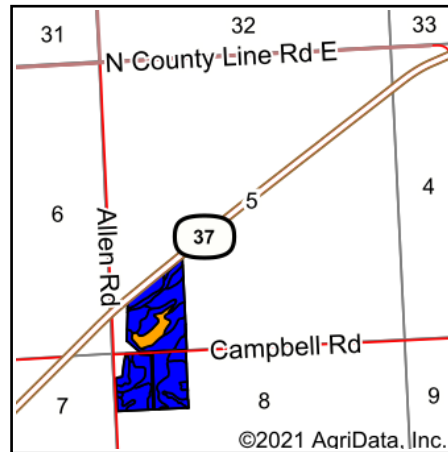

Soils data provided by USDA and NRCS.



State: **Indiana**
 County: **Allen**
 Location: **5-32N-15E**
 Township: **Scipio**
 Acres: **59.68**
 Date: **3/12/2021**



Area Symbol: IN003, Soil Area Version: 20

Code	Soil Description	Acres	Percent of field	Non-Irr Class Legend	Non-Irr Class	Corn	Corn silage	Grass legume hay	Grass legume pasture	Pasture	Soybeans	Winter wheat
Rs	Rensselaer silty clay loam	11.37	19.1%		llw	175	24	6		12	49	70
HoA	Whitaker loam, 0 to 2 percent slopes	9.21	15.4%		llw	140	20	5		9	46	63
HpA	Whitaker silt loam, 0 to 2 percent slopes	8.62	14.4%		llw	140	20	5		9	46	63
HoB	Whitaker loam, 2 to 6 percent slopes	6.35	10.6%		lle	140	20	5		9	46	63
FmC2	Fox loam, till plain, 6 to 12 percent slopes, eroded	4.53	7.6%		llle	89		3	6		31	44
McB	Martinsville loam, 2 to 6 percent slopes	4.25	7.1%		lle	145		5		10	51	72
BmA	Blount loam, interlobate moraines, 0 to 2 percent slopes	3.64	6.1%		llw	142	17	5		9	52	56
BeB	Belmore fine sandy loam, 2 to 6 percent slopes	3.04	5.1%		lle	126	19	5		8	44	63
MrB	Glynwood silt loam, 2 to 6 percent slopes	2.86	4.8%		lle	133		4	8		46	60
Pe	Pewamo silty clay loam, 0 to 1 percent slopes	2.60	4.4%		llw	157		5	11		47	64
HcA	Hoytville silty clay loam, 0 to 1 percent slopes	2.22	3.7%		llw	167		5			52	72
HaB	Haskins loam, 2 to 6 percent slopes	0.62	1.0%		lle	156		5	11		58	62
McB2	Martinsville loam, 2 to 6 percent slopes, moderately eroded	0.29	0.5%		lle	140	21	5		9	49	70
Rm	Rensselaer loam, 0 to 1 percent slopes	0.08	0.1%		llw	167		6		11	49	68
Weighted Average						144.2	14.8	5	1.4	7.7	46.5	63.4

Soils data provided by USDA and NRCS.