

Tuesday, August 13 • 6 PM
held on site

LAND Auction

OFFERED IN 5 TRACTS

86[±] Acres

2 HOMES • PRIVATE RURAL SETTING
WOODED - Recreational, Hunting, Timber Land
PASTURE LAND • GORGEOUS VIEWS
GAS & OIL RIGHTS

Northwest Pennsylvania



2 HOMES • PRIVATE RURAL SETTING
WOODED - Recreational, Hunting, & Timber Land
PASTURE LAND • GORGEOUS VIEWS
GAS & OIL RIGHTS

Owners moving out of state



LINESVILLE, PENNSYLVANIA • Crawford Co., Conneaut Twp.
Northwest Pennsylvania

86[±] Acres

OFFERED IN 5 TRACTS

LAND Auction

Tuesday, August 13 • 6 PM

Auction held on site



SchraderAuction.com

Follow us on: YouTube, Facebook, Twitter

Sun	Mon	Tue	Wed	Thu	Fri	Sat
25	26	27	28	29	30	31
18	19	20	21	22	23	24
11	12	13	14	15	16	17
4	5	6	7	8	9	10
			1	2	3	
AUGUST 2013						

email: auctions@schraderauction.com
800-451-2709 • 260-244-7606
950 N. Liberty Drive
Columbia City, IN 46725



Tuesday, August 13 • 6 PM
held on site

LAND Auction

OFFERED IN 5 TRACTS

86[±] Acres

Northwest Pennsylvania

2 HOMES • PRIVATE RURAL SETTING
WOODED - Recreational, Hunting, Timber Land
PASTURE LAND • GORGEOUS VIEWS
GAS & OIL RIGHTS



2 HOMES • PRIVATE RURAL SETTING
WOODED - Recreational, Hunting, & Timber Land
PASTURE LAND • GORGEOUS VIEWS
GAS & OIL RIGHTS

Owners moving out of state



LINESVILLE, PENNSYLVANIA • Crawford Co., Conneaut Twp.
Northwest Pennsylvania

86[±] Acres

OFFERED IN 5 TRACTS

LAND Auction

Tuesday, August 13 • 6 PM

Auction held on site



SchraderAuction.com

Follow us on: YouTube, Facebook, Twitter

Sun	Mon	Tue	Wed	Thu	Fri	Sat
25	26	27	28	29	30	31
18	19	20	21	22	23	24
11	12	13	14	15	16	17
4	5	6	7	8	9	10
			1	2	3	
AUGUST 2013						

email: auctions@schraderauction.com
800-451-2709 • 260-244-7606
950 N. Liberty Drive
Columbia City, IN 46725



86± Acres LAND Auction

2 HOMES • PRIVATE RURAL SETTING
WOODED - RECREATIONAL, HUNTING, & TIMBER LAND
PASTURE LAND • GORGEOUS VIEWS
GAS & OIL RIGHTS

Tuesday, August 13 • 6PM

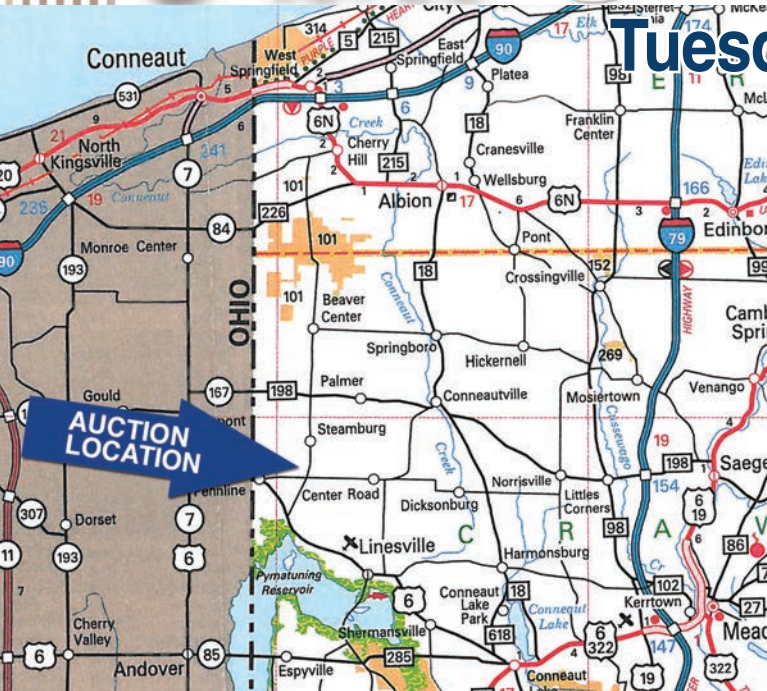

**AUCTION & PROPERTY LOCATION:
2338 WEST CENTER ROAD
LINESVILLE, PENNSYLVANIA 16424**

DIRECTIONS: From Linesville, travel on US 6 W. for 4.2 miles. At Beaver Center Road, turn north and travel northeast for 1.8 miles. Turn west on West Center Rd./SR 4004 and travel .3 mile to property on both sides of the road.

- 6 MILES FROM LINESVILLE, PA
- 13 MILES FROM MEADVILLE, PA
- 35 MILES FROM YOUNGSTOWN, OH
- 75 MILES FROM CLEVELAND, OH
- 85 MILES FROM PITTSBURG, PA

Inspection Dates:

Tuesday, July 23, 5-7PM & Monday, August 12, 5-7PM



TRACT 1: 31 ± acres of mostly wooded land. This tract offers a combination of hardwood trees, a pond, and some open land with frontage along W. Center Rd. Investigate the income potential, hunting, and recreational value of this land.

TRACT 2: 11.5± acres with much to offer! This tract includes a 5-bedroom home on a full walk-out basement and several outbuildings. The spacious home features a large eat-in kitchen with oak cabinets; a summer kitchen finished with tongue-and-groove walls; 6-panel doors and vinyl windows throughout; lots of storage space; and a wrap-around porch. The outbuildings would be great for livestock, storage, or a business at home.

- 60' x 54' workshop with concrete floor, end sliders, and a 40' x 19' lean-to
- 40' x 26' workshop with concrete floor and a 40' x 10' lean-to
- 40' x 28' 9-stall barn with concrete floor, overhead hay storage, end sliders and a 40' x 19' lean-to
- Well house

Room Dimensions Home on Tract 2	
MAIN FLOOR	
Living Room	30' x 23'
Kitchen	22' x 22'
Summer Kit.	15' x 12'
Mud Room	8' x 5'
Bedroom 1	12' x 11'
Bedroom 2	11' x 9'
UPSTAIRS	
Bedroom 3	12' x 11'
Bedroom 4	12' x 10'
Bedroom 5	10' x 10'
Nursery	11' x 5'

TRACT 3 (Swing Tract): 24.5± acres with pasture and wooded land. The brook provides water for livestock. This tract must be bid in combination with Tract 1, Tract 2, or by an adjoining neighbor.

TRACT 4: 10± acres of pasture land with a 5-bedroom home and outbuildings. The home has a full walk-out basement, vinyl windows throughout, large rooms, and a 30' x 8' back porch with a ramp. The home is still in need of some finish work. The outbuildings include a 52' x 32' barn with tie-stalls and overhead hay

Room Dimensions Home on Tract 4	
MAIN FLOOR	
Living Room	21' x 10'
Kitchen / Dining Rm.	22' x 22'
Bedroom 1	14' x 9'
UPSTAIRS	
Bedroom 2	23' x 18'
Bedroom 3	23' x 9'
Bedroom 4	15' x 12'
Bedroom 5	11' x 9'

storage and a 20' x 18' well house with a concrete floor. The pasture is partially wooded and has a brook. This property is ideal for livestock.

TRACT 5 (Swing Tract): 9± acres of wooded pasture land. This tract must be bid in combination with Tract 4 or by an adjoining neighbor.



OWNERS: VICTOR AND ELIZABETH SCHWARTZ
AUCTION MANAGERS: Roger Diehm 260-318-2770 and Dale Evans 260-894-0458

SCHRADER 800-451-2709
Real Estate and Auction Company, Inc. SchraderAuction.com

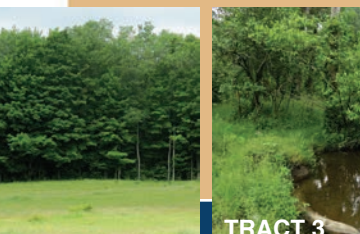

AUCTION TERMS & CONDITIONS:

PROCEDURE: The property will be offered in 5 individual tracts, any combination of tracts and as a total 86± acre unit. There will be open bidding on all tracts (with swing tract limitations) and combinations during the auction as determined by the Auctioneer. Bids on tracts, tract combinations and the total property may compete.

DOWN PAYMENT: 10% down payment on the day of auction for individual tracts or combinations of tracts. The down payment may be made in the form of cashier's check, personal check, or corporate check. Your bidding is not conditional upon financing, so be sure you have arranged financing, if needed, and are capable of paying cash at closing.

BUYER'S PREMIUM: A Buyer's Premium of 10% shall be added to the winning bids and paid by the Buyer(s) as part of the Total Contract Purchase Price.

ACCEPTANCE OF BID PRICES: All successful bidders will be required to enter into Purchase Agreements at the auction site immediately following the close of the auction. All final bid prices are subject to the Sellers' acceptance or rejection.

EVIDENCE OF TITLE: The Seller shall provide a preliminary opinion of title to be made available to prospective bidders for review prior to bidding. If any buyer elects to purchase title insurance, the cost thereof shall be at such buyer's sole expense. Seller agrees to provide merchantable title to the property subject to matters of record, general conditions of title, and similar or related matters. All tracts sold "AS IS".

DEED: A Warranty deed will be delivered at closing.

CLOSING: Closing shall take place 30 days after auction date, or as soon thereafter as applicable closing documents are completed.

POSSESSION: Possession of the property shall be given the day of closing.

REAL ESTATE TAXES: Shall be prorated to the day of closing.

ACREAGE: All boundaries are approximate and have been estimated base on current legal descriptions.

SURVEY: A new survey will be made where there is no existing legal description or where new boundaries are created by the tract divisions in this auction. Buyer(s) and Seller shall share survey expense 50:50.

OIL & GAS LEASE/MINERAL RIGHTS: The sale shall include the mineral rights and oil and gas leases owned by the Seller.

AGENCY: Schrader Real Estate & Auction Company, Inc. and its representatives are exclusive agents of the Seller.

DISCLAIMER AND ABSENCE OF WARRANTIES: All information contained in this brochure and all related materials are subject to the terms and conditions outlined in the Purchase Agreement. The property is being sold on an "AS IS, WHERE IS" basis, and no warranty or representation, either expressed or implied, concerning the property is made by the Seller or the Auction Company. All sketches and dimensions in the brochure are approximate. Each potential bidder is responsible for conducting his or her own independent inspections, investigations, inquiries, and due diligence concerning the property. The information contained in this brochure is subject to verification by all parties relying on it. No liability for its accuracy, errors, or omissions is assumed by the Seller or the Auction Company. Conduct of the auction and increments of bidding are at the direction and discretion of the Auctioneer. The Seller and Selling Agents reserve the right to preclude any person from bidding if there is any question as to the person's credentials, fitness, etc. All decisions of the Auctioneer are final.

ANY ANNOUNCEMENTS MADE THE DAY OF THE SALE TAKE PRECEDENCE OVER PRINTED MATERIAL OR ANY OTHER ORAL STATEMENTS MADE.

86± Acres LAND Auction

2 HOMES • PRIVATE RURAL SETTING
WOODED - RECREATIONAL, HUNTING, & TIMBER LAND
PASTURE LAND • GORGEOUS VIEWS
GAS & OIL RIGHTS

Tuesday, August 13 • 6PM

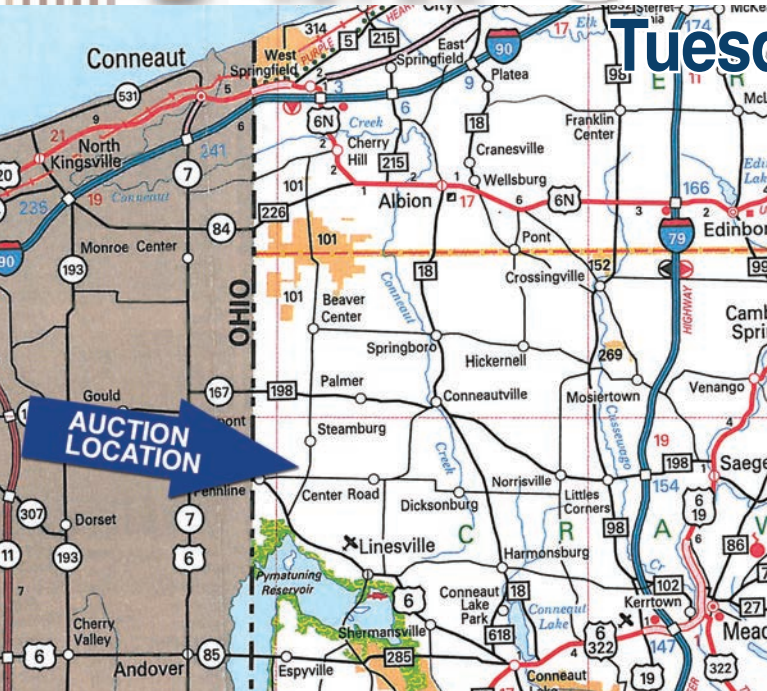

**AUCTION & PROPERTY LOCATION:
2338 WEST CENTER ROAD
LINESVILLE, PENNSYLVANIA 16424**

DIRECTIONS: From Linesville, travel on US 6 W. for 4.2 miles. At Beaver Center Road, turn north and travel northeast for 1.8 miles. Turn west on West Center Rd./SR 4004 and travel .3 mile to property on both sides of the road.

- 6 MILES FROM LINESVILLE, PA
- 13 MILES FROM MEADVILLE, PA
- 35 MILES FROM YOUNGSTOWN, OH
- 75 MILES FROM CLEVELAND, OH
- 85 MILES FROM PITTSBURG, PA

Inspection Dates:

Tuesday, July 23, 5-7PM & Monday, August 12, 5-7PM



TRACT 1: 31 ± acres of mostly wooded land. This tract offers a combination of hardwood trees, a pond, and some open land with frontage along W. Center Rd. Investigate the income potential, hunting, and recreational value of this land.

TRACT 2: 11.5± acres with much to offer! This tract includes a 5-bedroom home on a full walk-out basement and several outbuildings. The spacious home features a large eat-in kitchen with oak cabinets; a summer kitchen finished with tongue-and-groove walls; 6-panel doors and vinyl windows throughout; lots of storage space; and a wrap-around porch. The outbuildings would be great for livestock, storage, or a business at home.

- 60' x 54' workshop with concrete floor, end sliders, and a 40' x 19' lean-to
- 40' x 26' workshop with concrete floor and a 40' x 10' lean-to
- 40' x 28' 9-stall barn with concrete floor, overhead hay storage, end sliders and a 40' x 19' lean-to
- Well house

Room Dimensions Home on Tract 2	
MAIN FLOOR	
Living Room	30' x 23'
Kitchen	22' x 22'
Summer Kit.	15' x 12'
Mud Room	8' x 5'
Bedroom 1	12' x 11'
Bedroom 2	11' x 9'
UPSTAIRS	
Bedroom 3	12' x 11'
Bedroom 4	12' x 10'
Bedroom 5	10' x 10'
Nursery	11' x 5'

TRACT 3 (Swing Tract): 24.5± acres with pasture and wooded land. The brook provides water for livestock. This tract must be bid in combination with Tract 1, Tract 2, or by an adjoining neighbor.

TRACT 4: 10± acres of pasture land with a 5-bedroom home and outbuildings. The home has a full walk-out basement, vinyl windows throughout, large rooms, and a 30' x 8' back porch with a ramp. The home is still in need of some finish work. The outbuildings include a 52' x 32' barn with tie-stalls and overhead hay

Room Dimensions Home on Tract 4	
MAIN FLOOR	
Living Room	21' x 10'
Kitchen / Dining Rm.	22' x 22'
Bedroom 1	14' x 9'
UPSTAIRS	
Bedroom 2	23' x 18'
Bedroom 3	23' x 9'
Bedroom 4	15' x 12'
Bedroom 5	11' x 9'

storage and a 20' x 18' well house with a concrete floor. The pasture is partially wooded and has a brook. This property is ideal for livestock.

TRACT 5 (Swing Tract): 9± acres of wooded pasture land. This tract must be bid in combination with Tract 4 or by an adjoining neighbor.



AUCTION TERMS & CONDITIONS:

PROCEDURE: The property will be offered in 5 individual tracts, any combination of tracts and as a total 86± acre unit. There will be open bidding on all tracts (with swing tract limitations) and combinations during the auction as determined by the Auctioneer. Bids on tracts, tract combinations and the total property may compete.

DOWN PAYMENT: 10% down payment on the day of auction for individual tracts or combinations of tracts. The down payment may be made in the form of cashier's check, personal check, or corporate check. Your bidding is not conditional upon financing, so be sure you have arranged financing, if needed, and are capable of paying cash at closing.

BUYER'S PREMIUM: A Buyer's Premium of 10% shall be added to the winning bids and paid by the Buyer(s) as part of the Total Contract Purchase Price.

ACCEPTANCE OF BID PRICES: All successful bidders will be required to enter into Purchase Agreements at the auction site immediately following the close of the auction. All final bid prices are subject to the Sellers' acceptance or rejection.

EVIDENCE OF TITLE: The Seller shall provide a preliminary opinion of title to be made available to prospective bidders for review prior to bidding. If any buyer elects to purchase title insurance, the cost thereof shall be at such buyer's sole expense. Seller agrees to provide merchantable title to the property subject to matters of record, general conditions of title, and similar or related matters. All tracts sold "AS IS".

DEED: A Warranty deed will be delivered at closing.

CLOSING: Closing shall take place 30 days after auction date, or as soon thereafter as applicable closing documents are completed.

POSSESSION: Possession of the property shall be given the day of closing.

REAL ESTATE TAXES: Shall be prorated to the day of closing.

ACREAGE: All boundaries are approximate and have been estimated base on current legal descriptions.

SURVEY: A new survey will be made where there is no existing legal description or where new boundaries are created by the tract divisions in this auction. Buyer(s) and Seller shall share survey expense 50:50.

OIL & GAS LEASE/MINERAL RIGHTS: The sale shall include the mineral rights and oil and gas leases owned by the Seller.

AGENCY: Schrader Real Estate & Auction Company, Inc. and its representatives are exclusive agents of the Seller.

DISCLAIMER AND ABSENCE OF WARRANTIES: All information contained in this brochure and all related materials are subject to the terms and conditions outlined in the Purchase Agreement. The property is being sold on an "AS IS, WHERE IS" basis, and no warranty or representation, either expressed or implied, concerning the property is made by the Seller or the Auction Company. All sketches and dimensions in the brochure are approximate. Each potential bidder is responsible for conducting his or her own independent inspections, investigations, inquiries, and due diligence concerning the property. The information contained in this brochure is subject to verification by all parties relying on it. No liability for its accuracy, errors, or omissions is assumed by the Seller or the Auction Company. Conduct of the auction and increments of bidding are at the direction and discretion of the Auctioneer. The Seller and Selling Agents reserve the right to preclude any person from bidding if there is any question as to the person's credentials, fitness, etc. All decisions of the Auctioneer are final.

ANY ANNOUNCEMENTS MADE THE DAY OF THE SALE TAKE PRECEDENCE OVER PRINTED MATERIAL OR ANY OTHER ORAL STATEMENTS MADE.