

REAL ESTATE

Listing

CROPLAND FOR SALE

**GREAT LOCATION: BETWEEN
LOSANTVILLE AND MOORELAND IN
HENRY COUNTY, INDIANA**

OWNERS: O & N FARMS, INC



**PRICE: \$243,750
\$6,250/ACRE**



**TOTAL ACRES
39± ACRES**

- **QUIET RURAL LOCATION NEAR WAYNE COUNTY LINE**
- **ALL CROPLAND**
- **ESTABLISHED WATERWAY**
- **GOOD EASE OF OPERATION**
- **GOOD FRONTAGE ON Co. Rd. 950E**
- **ESTIMATED TAXES: \$904/YEAR IN 2020**
- **SOIL INDEX 136 BU.**

LOCATION:

**½ MILE WEST OF WAYNE COUNTY LINE. FROM HWY. 36 SOUTH ON Co. Rd. 900E
THEN EAST ON Co. Rd. 450N THEN SOUTH ON 950E ½ MILE ON WEST SIDE.**

The information on this sheet is subject to verification and no liability for errors or omissions is assumed by the Schrader Agency.

O & N • SS61H



800.451.2709
schraderauction.com/listings

Listing Agent: Steve Slonaker
877-747-0212
schrder@parallax.ws

REAL ESTATE

Listing

CROPLAND FOR SALE

TOTAL ACRES PRICE: \$243,750
39± ACRES \$6,250/ACRE

• HENRY COUNTY, IN
EAST OF MOORELAND ON CR 950 E
AND WEST OF LOSANTVILLE

AREA MAP



SOIL MAP

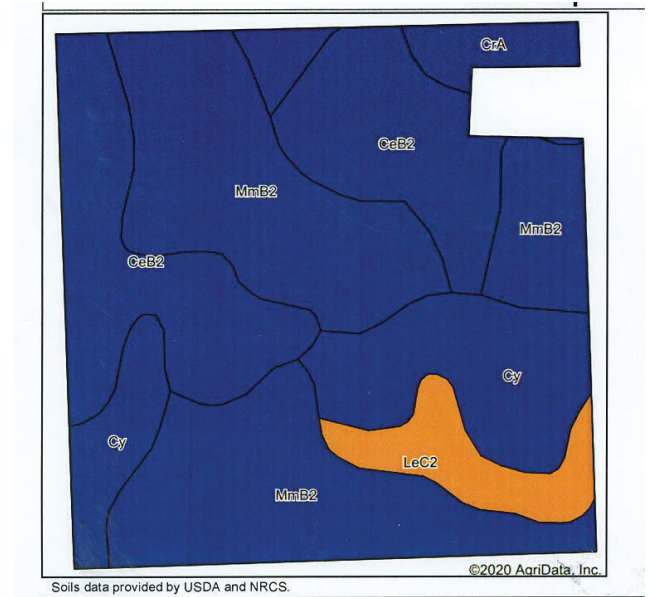

LOCATION MAP

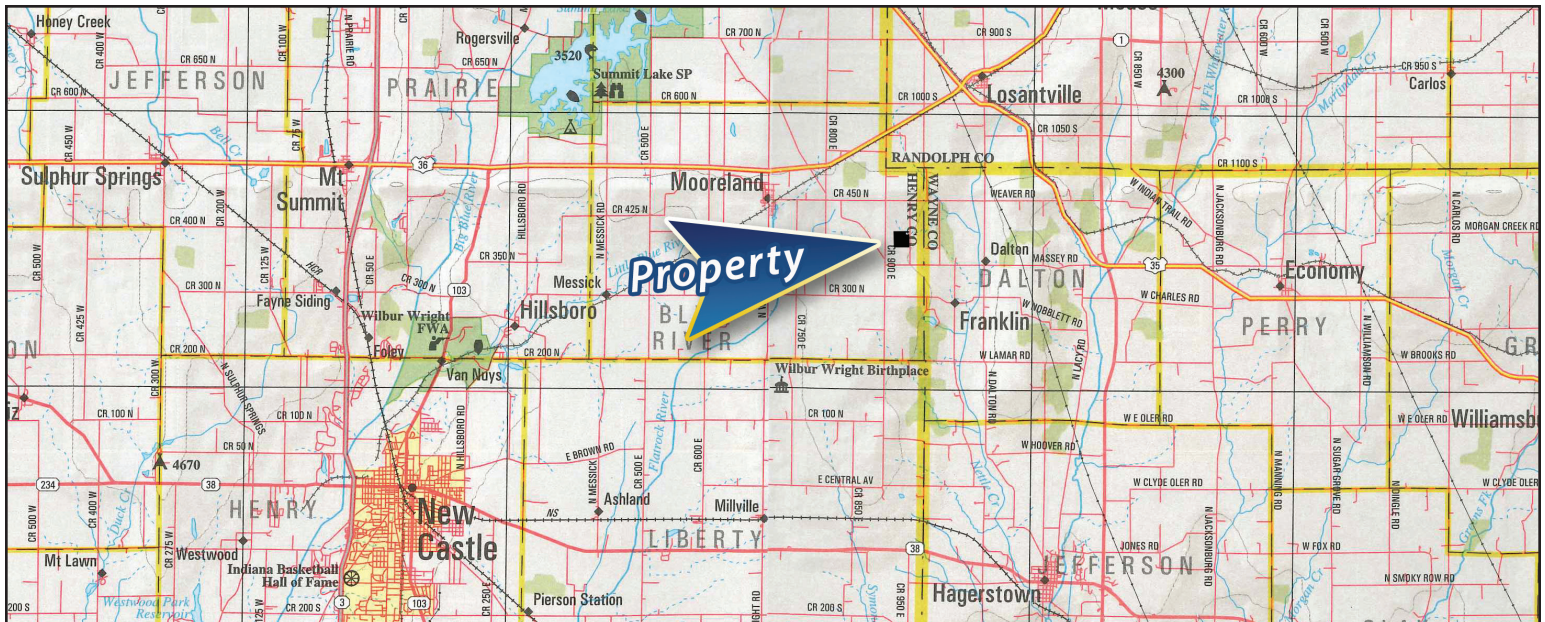

The information on this sheet is subject to verification and no liability for errors or omissions is assumed by the Schrader Agency.

O & N • SS61H