

KANSAS CITY AREA EQUIPMENT AUCTION



Wednesday, March 31 • 10am CST

Cleveland, Missouri

March	Su	M	Tu	W	Th	F	Sa
		1	2	3	4	5	6
	7	8	9	10	11	12	13
	14	15	16	17	18	19	20
	21	22	23	24	25	26	27
28	29	30	31				



Roger Diehm • 800.451.2709
Schrader Real Estate & Auction Company, Inc.

Follow us on: Get our iOS App:

TERMS: Cash or Check w/proper ID. 4% surcharge for credit cards. Announcements made the day of the auction take precedence over any printed material. Not responsible for accidents.



Corporate Headquarters:
950 N Liberty Dr Columbia City, IN 46725
800.451.2709 • www.SchraderAuction.com

KANSAS CITY AREA EQUIPMENT AUCTION

Wednesday, March 31 • 10am CST



• Hopper Bottoms • Semis • Trailers
• Trucks • Conveyors • Cultivator

• Plow • Fuel Tanks • Seeders
• Welders • Mowers • And More!



800.451.2709 • www.SchraderAuction.com



KANSAS CITY AREA EQUIPMENT AUCTION

Wednesday, March 31 • 10am CST

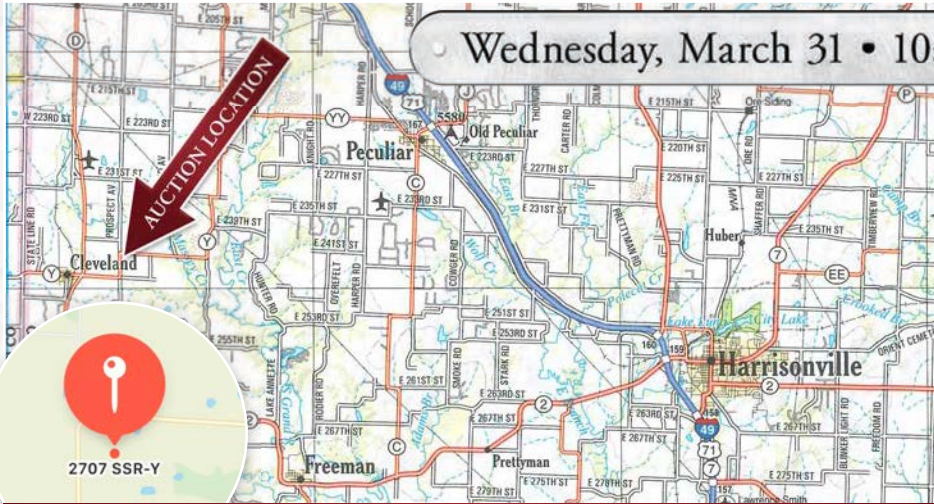

AUCTION LOCATION: 2707 State Route Y, Cleveland, MO • Look for signs!



- 2015 42' Timpfe Hopper Bottom, Air ride, Roll tarp
- 2015 42' Timpfe Hopper Bottom, Air ride, Roll tarp
- 2015 42' Timpfe Hopper Bottom, Air ride, Roll tarp
- 1997 Ravens Dump Trailer, Air ride, roll tarp, air axle
- 2011 Convey-all CST32-C seed tender on 1992 Monon Tri-axle Trailer, Spring ride, 4 hopper, Belt conveyor, on board Kohler electric start motor, Electric tarp
- 2009 Neville drop deck trailer, 36' deck, 11' deck over fifth wheel, 5' beaver tail w/(3) ramps, spread axle, air ride, 255/70R22.5 tires
- 41' Great Dane semi trailer, under body box, 11R24.5 tires
- 45' Trailmobile semi trailer, 11R22.5 tires
- 1999 Freightliner Semi-tractor, 10 speed, Detroit series 60, Wet kit, Aluminum outer rims, Air ride, Air ride cab, Shows 712,245 miles (3/2/21)
- 2003 Freightliner Semi-tractor, 10 speed, Detroit series 60, Aluminum outer rims, Air ride, Air ride cab, Shows 760,003 miles (3/2/21)
- 1999 Freightliner Semi-tractor, 8 speed, Detroit series 60, Aluminum outer rims, Air ride, Air ride cab, Shows 632,231 miles (3/2/21)
- 2001 Freightliner Semi-tractor, 10 speed, Detroit series 60, Aluminum outer rims, Air ride, Air ride cab, (Rear end is out on back rear end, gear has broken the housing), Shows 691,411 miles (3/2/21)
- 2003 Freightliner Semi-tractor, 10 speed, Detroit series 60, Aluminum outer rims, Air ride, Air ride cab, Shows 780,343 miles (3/2/21)
- 2006 Ford F-350 Service Truck, 7.3 Powerstroke, auto. trans., Knapheide Service bed, Shows 215,626 miles (3/2/21), Miller Blue Star 180K Constant current DC welder, 5000W generator, Kohler 12.5 hp elec. start, Porter Cable 185 PSI max air compressor, 1.6 hp, 20 gal. tank, fuel tank w/GPI 105S pump
- 2007 Chevy Silverado 1500, auto., 4 door, Short bed, shows 264,048 mi.
- 2011 Doyle 24" Belt Conveyor, 9' unload, 22' convey, Honda GX 630 Motor, Elec. Start, Shows 71 hours (3/3/21)
- Rapat Series 2000 Conveyor, 18"x28", 220 electric
- Sitrex Magnum MK 10-12, 12 wheel hay rake
- 2008 38' DMI Tiger Mate II field cultivator, walking tandems main & wings, double fold, hyd. leak on one double fold cylinder
- DMI Hydra Wide 6 Bottom Plow, semi mount, gauge wheel missing

- 32' Krause 4990 disc, rock flex, 19" front blades, 21" rear blades, tandem on main & wings, gauge wheels on wings, one gang out on back for bearing replacement placed on skid, hyd lift cylinder off for repair, hyd fold cylinder off for repair
- 10,000 Gal. Diesel Fuel Tank w/fill platform, Marlow pump
- 40' 1974 Fruehauf tanker trailer, 8600 gal. capacity
- 1974 40' Fruehauf tanker, 8600 gal. capacity
- JD 84" Material Bucket
- 4 Tine Bale Spear, JD Attach
- Skid Steer Attach Hitch
- CID Stump/Root Bucket, Skid steer attach
- HLA Bale Grapple, Model WOKBO 500
- 70" Dymax Brush Hog Mower
- Cosmo 3 pt seeder
- Tree shear, skid steer attach.
- 3 pt bale spear
- 2008 Kawasaki Mule 610 UTV, gas, 4x4, Shows 1247 hrs (3/3/21)
- Ford 8N tractor, 3 pt, pto, will not start
- Toro Groundsmaster 580-D Commercial Mower, 7' Center Mower, (2) 5' Wing decks, Diesel, Shows 3544 hrs. (3/3/21), some blades & guards missing
- 16' tandem axle trailer, full ramp
- New Holland 617 Disk Mower, 3pt, 540 PTO
- JD HX15 Batwing mower, Airplane tires, chains, pto adapter to 540
- 2007 Toyota 9000 lb Fork Lift, Gas/LP, Side Shifter, 3 stage, hard tire, Shows 4298 hours (3/3/21)
- Man lift basket
- 2017 JD 1990 40' Air seeder, CCS Seed Delivery
- 15' box grader, tandem axle, dual lift cylinder
- Lincoln 225 AC/DC arc welder & cart, tank not included
- JD 9' grader blade, hyd. tilt & angle
- Lincoln Mig welder, power mag & cart, tank not included
- 2005 Ferris IS 5000 Zero Turn Mower, CAT Diesel, 72" deck, suspension ride, hours unknown
- 6' roller, concrete filled, located off auction site



Inspection Dates:

Thur, Mar. 18 • 10am-5pm
& Tue, Mar. 30 • 9am-Noon

SCHRADER
Real Estate and Auction Company, Inc.

LIVE INTERNET BIDDING
Visit SchraderAuction.com for Details
or call 800-451-2709

800.451.2709 • SchraderAuction.com

Seller: Seba Bros. Farms By & Through its Court
Appointed Receiver TB Realty & Development, Inc.
Auction Manager: Roger Diehm • 800.451.2709