

# Soils Map

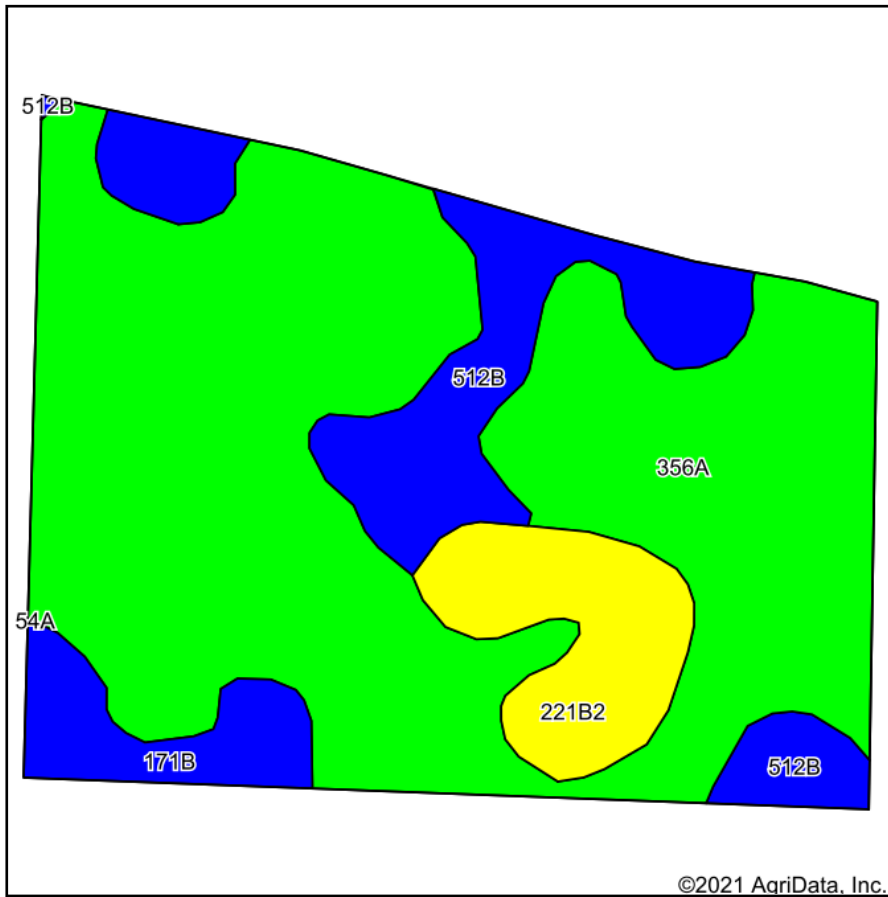

Soils data provided by USDA and NRCS.

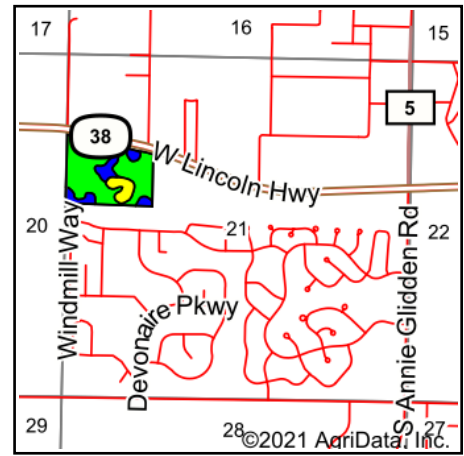

State: **Illinois**  
 County: **De Kalb**  
 Location: **21-40N-4E**  
 Township: **DeKalb**  
 Acres: **29.23**  
 Date: **12/1/2021**

**SCHRADER**  
 Real Estate and Auction Company, Inc.

Maps Provided By:  
**surety**  
 CUSTOMIZED ONLINE MAPPING  
 © AgriData, Inc. 2021 www.AgriDataInc.com



Area Symbol: IL037, Soil Area Version: 16

Code	Soil Description	Acres	Percent of field	Il. State Productivity Index Legend	Subsoil rooting <sup>a</sup>	Corn Bu/A	Soybeans Bu/A	Wheat Bu/A	Oats Bu/A <sup>b</sup>	Sorghum <sup>c</sup> Bu/A	Alfalfa <sup>d</sup> hay, T/A	Grass-legume <sup>e</sup> hay, T/A	Crop productivity index for optimum management
356A	Elpaso silty clay loam, 0 to 2 percent slopes	20.69	70.8%		FAV	195	63	66	102	0	0.00	5.77	144
**512B	Danabrook silt loam, 2 to 5 percent slopes	4.48	15.3%		FAV	**185	**58	**72	**99	0	**6.34	0.00	**137
**221B2	Parr silt loam, 2 to 5 percent slopes, eroded	2.57	8.8%		FAV	**151	**49	**61	**65	0	**5.12	0.00	**113
**171B	Catlin silt loam, 2 to 5 percent slopes	1.49	5.1%		FAV	**185	**58	**72	**98	0	**6.70	0.00	**137
Weighted Average						189.1	60.7	66.8	98.1	*-	1.76	4.08	139.8

**Table: Optimum Crop Productivity Ratings for Illinois Soil by K.R. Olson and J.M. Lang, Office of Research, ACES, University of Illinois at Champaign-Urbana.** Version: 1/2/2012 Amended Table S2 B811

Crop yields and productivity indices for optimum management (B811) are maintained at the following NRES web site: <http://soilproductivity.nres.illinois.edu/>

\*\* Indexes adjusted for slope and erosion according to Bulletin 811 Table S3

<sup>a</sup> UNF = unfavorable; FAV = favorable

<sup>b</sup> Soils in the southern region were not rated for oats and are shown with a zero "0".

<sup>c</sup> Soils in the northern region or in both regions were not rated for grain sorghum and are shown with a zero "0".

<sup>d</sup> Soils in the poorly drained group were not rated for alfalfa and are shown with a zero "0".

<sup>e</sup> Soils in the well drained group were not rated for grass-legume and are shown with a zero "0".

Soils data provided by USDA and NRCS. Soils data provided by University of Illinois at Champaign-Urbana.