

Prairie Edge Farms

POTATO EQUIPMENT AUCTION

Corporate Headquarters:
950 N Liberty Drive, PO Box 508,
Columbia City, IN 46725



Sturgis, MI
Thursday, May 30 at 9:30am

TERMS: Cash or Check w/ proper ID. 3% convenience fee for credit cards. Announcements made the day of the auction take precedence over any printed material, and oral statements made. Lunch available. Not responsible for accidents.

MAY	Su	M	Tu	W	Th	F	Sa
	5	6	7	8	9	10	11
	12	13	14	15	16	17	18
	19	20	21	22	23	24	25
	26	27	28	29	30	31	



Auction Manager:
Robert Mishler • 260.336.9750
Schrader Real Estate and
Auction Company, Inc.

Get Our **iOS App:** Follow Us On: **YouTube**



800.451.2709 • SchraderAuction.com

Prairie Edge Farms

POTATO EQUIPMENT AUCTION

Sturgis, MI
Thursday, May 30 at 9:30am

- Tractors • Excavator • JD Planter
- Harriston Potato Planter
- Stone Picker • Potato Trucks
- Potato Harvesters • Windrowers
- Potato Sorting Line • Conveyors
- JD 8000 Tires • Rims



800.451.2709
SchraderAuction.com



Sturgis, MI
Thursday, May 30 at 9:30am

- Tractors
- Excavator
- JD Planter
- Harriston Potato Planter
- Stone Picker
- Potato Trucks
- Potato Harvesters
- Windrowers
- Potato Sorting Line
- Conveyors
- JD 8000 Tires
- Rims



800.451.2709
SchraderAuction.com



Prairie Edge Farms

POTATO EQUIPMENT AUCTION

Due to the passing of Ed Schlabach after his battle with cancer, the Schlabach and Sturgis families have decided to discontinue the potato production portion of their farming operation. They wish to thank everyone for your thoughts and prayers during this time and thank everyone for your interest in their auction.

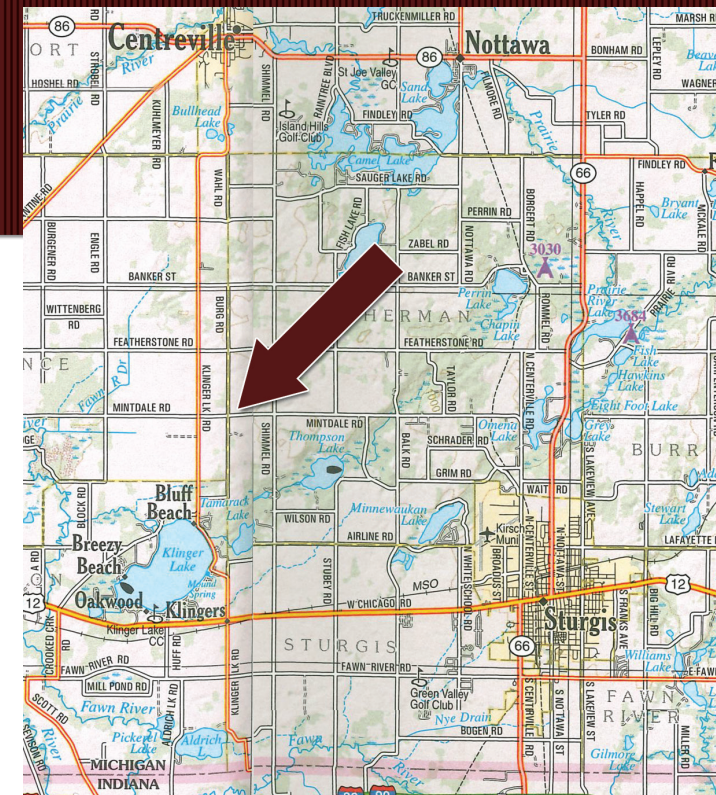

LOCATION (AUCTION HELD ONSITE):
22230 Mintdale Rd, Sturgis, MI 49094 • 4.5 miles west of Sturgis, MI on US 12 to Shimmel Rd, then north 3 miles to Mintdale Rd, west .75 mile to auction site.

Sturgis, MI
**Thursday,
May 30
at 9:30am**



INSPECTION DATES:
Mon, May 13 • 10am-12pm
& Wed, May 29 • 3-5pm



Owners:
Prairie Edge Farms, LLC
Tyler • 269.503.3702 &
Dustin • 269.506.5929
Auction Manager:
Robert Mishler • 260.336.9750

LIVE INTERNET BIDDING
Visit SchraderAuction.com for Details
or call 800-451-2709.

SCHRADER
Real Estate and Auction Company, Inc.

800.451.2709
SchraderAuction.com

TRACTORS • EXCAVATOR

- **2003 John Deere 8120 MFWD**, Green Star ready, 4 remotes, QH, 380/85R-34 front and 380/90R-50 rears, 7,085 hours
- **John Deere 4555 MFWD**, 3 remotes, quick hitch, 14.9-46 duals, 380/85R 30 tires, 13,132 hours
- **Hitachi EX200 excavator mech thumb**, bucket, 60" root bucket, 11,648 hours

JD PLANTER • STONE PICKER • FARM EQUIPMENT

- **John Deere 1790**, 16/31 TC air clutch, air bag down pressure, no till coulters seed firmers, markers
- **Potato equipment, Corp.** 60 inch rock picker 3pt vine cutter
- **IH 5500**, 13 shank 3PT chisel plow

POTATO TRUCKS • SEMI TRACTOR

- **IH S 2500 DT466 eng**, 10 spd SSL trans, DLL smooth belt with electric over hydraulic drive bed
- **1995 Freightliner FLD**, M 11 Cummins, Eaton Fuller 10 speed needs trans work, wet kit has not been used in a few years, all alum rims, 285/70-24.5 tires
- **1985 White Cummins formula engine**, Eaton, fuller 15 speed,trans, air tag axle, 315/80 R 22.5 and 315/80R24.5 tires, Spudnik potato bed electric over hydraulic bed drive
- **1987 Ford L 9000 Cummins**, 7 speed trans, Thomas potato box smooth belt with electric over hydraulic drive

POTATO HARVESTERS - WINDROWERS

- **1996 Lenco 4 row harvester**, Cummins N14 engine less than 50 hours on NEW Crate engine from Cummins replaced in Aug 2023 and new hydraulic pump, stone box, 60" air box, 48x25-20 front and 66x43-25 rear tires very good tires
- **Lenco 4 row harvester Cummins**, 6,036 hours, 48" air head, 16.9-24 and 28L-26 rear tires very good rubber
- **Dahlman 2200 2 row pull type harvester**, pto pump with electric over hydraulic
- **Lockwood 2000 2 row windrower**, pto drive, switchable RH dump
- **Harriston 6 row potato planter**, pick style, John, blue liquid, fertilizer, pump, cab cameras, for each row and back up camera
- **Spudnik 5140 4 row windrower**, pto drive, steerable, Reversible RH discharge, vine cutter
- **Spudnik conveyor 10"x24'** 2 hp electric motor Rock separator



POTATO SORTING LINE • CONVEYORS

- **Ikes Welding 30" chain 12'4" length 48" raise**
- **Potato sorting tables**, (2) 23"x14' conveyor belts with 48"x48" size
- **Potato washer 58"x14'** - 28 58" brushes and sponges with secondary 11'6" sorting table with rollers, 2 10" trash/waste discharge conveyors
- **Potato Sorting Table Loader/Piler 18"x36'** smooth conveyor with 24" rubber feeder chain (movable)
- **Red small Conveyor 12"x20'** conveyor 12"x25' rubber belt conveyor

JD 8000 TIRES • RIMS • HUB EXTENSIONS

- **(4) 380/85R30** on rims
- **(2) 320/85R34** on rims
- **(4) Firestone 420/80R46 tires** on inside rims (have very good tread)
- **(4) Good Year 420/80R46 tires** on inside rims
- **(2) Good Year 420/80R46 tires** on 10 bolt rims

