

Soils Map

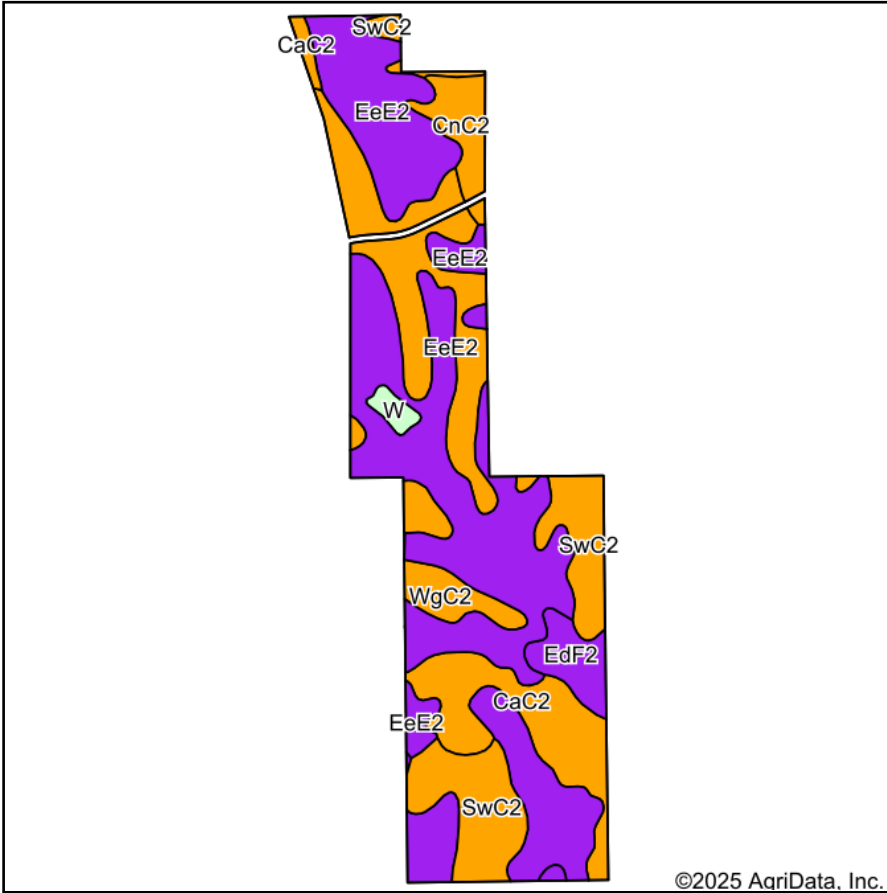

Soils data provided by USDA and NRCS.

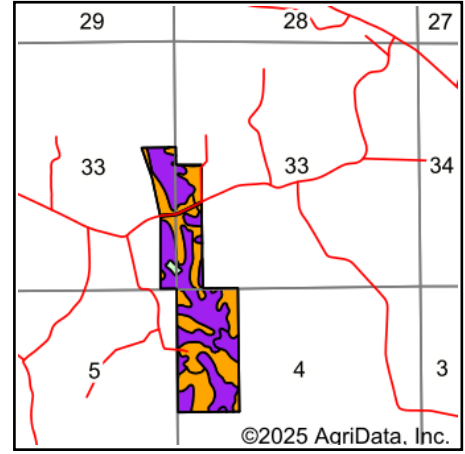

State: **Indiana**
 County: **Switzerland**
 Location: **33-3N-3W**
 Township: **Craig**
 Acres: **146.07**
 Date: **8/4/2025**



Area Symbol: IN155, Soil Area Version: 28

Code	Soil Description	Acres	Percent of field	Non-Irr Class Legend	Non-Irr Class	Alfalfa hay Tons	Corn Bu	Grass legume hay Tons	Pasture AUM	Soybeans Bu	Tobacco Lbs	Winter wheat Bu	
EeE2	Eden silty clay loam, 15 to 50 percent slopes, eroded	68.59	47.0%		Vle								
WgC2	Weisburg silt loam, 6 to 12 percent slopes, eroded	26.67	18.3%		IIIe	6	115	4	8	40	3150	52	
SwC2	Switzerland silt loam, 6 to 12 percent slopes, eroded	19.18	13.1%		IIIe		125	4	8	44		50	
CaC2	Carmel silty clay loam, 6 to 12 percent slopes, eroded	15.81	10.8%		IIIe		95	3	6	33		38	
EdF2	Eden flaggy silty clay, 25 to 50 percent slopes	9.14	6.3%		VIIe								
CnC2	Cincinnati silt loam, 6 to 12 percent slopes, eroded	5.32	3.6%		IIIe		114	4	8	40	2835	52	
W	Water	1.36	0.9%										
Weighted Average						*-	1.1	51.8	1.7	3.5	18.1	678.4	22.1

*- Non Irr Class weighted average cannot be calculated on the current soils data due to missing data.

Soils data provided by USDA and NRCS.