

# Soils Map

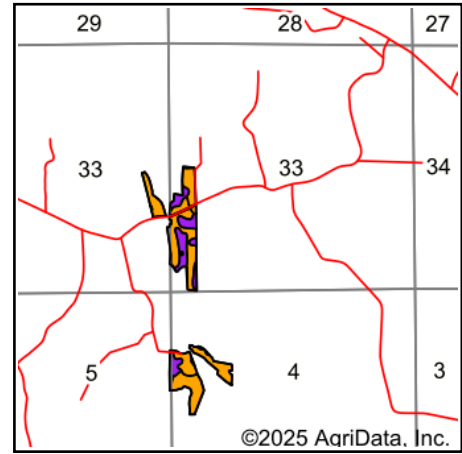

Soils data provided by USDA and NRCS.



State: **Indiana**  
 County: **Switzerland**  
 Location: **33-3N-3W**  
 Township: **Craig**  
 Acres: **48.3**  
 Date: **8/4/2025**



Area Symbol: IN155, Soil Area Version: 28

Code	Soil Description	Acres	Percent of field	Non-Irr Class Legend	Non-Irr Class	Alfalfa hay Tons	Corn Bu	Grass legume hay Tons	Pasture AUM	Soybeans Bu	Tobacco Lbs	Winter wheat Bu
WgC2	Weisburg silt loam, 6 to 12 percent slopes, eroded	16.88	35.0%		IIIe	6	115	4	8	40	3150	52
EeE2	Eden silty clay loam, 15 to 50 percent slopes, eroded	11.19	23.2%		VIe							
CaC2	Carmel silty clay loam, 6 to 12 percent slopes, eroded	8.33	17.2%		IIIe		95	3	6	33		38
SwC2	Switzerland silt loam, 6 to 12 percent slopes, eroded	7.20	14.9%		IIIe		125	4	8	44		50
CnC2	Cincinnati silt loam, 6 to 12 percent slopes, eroded	4.34	9.0%		IIIe		114	4	8	40	2835	52
EdF2	Eden flaggy silty clay, 25 to 50 percent slopes	0.36	0.7%		VIIe							
<b>Weighted Average</b>					<b>3.72</b>	<b>2.1</b>	<b>85.5</b>	<b>2.9</b>	<b>5.7</b>	<b>29.8</b>	<b>1355.6</b>	<b>36.9</b>

Soils data provided by USDA and NRCS.