

LOCATED: 1230 12 mile Rd, Burlington, MI 49029.
 From the intersection of I-69 and SR 60 go West on Michigan SR 60
 approx 3 1/2 miles to 12 Mile Rd then South to the auction.

Tuesday, December 9th • 10:30am
 Calhoun County, MI

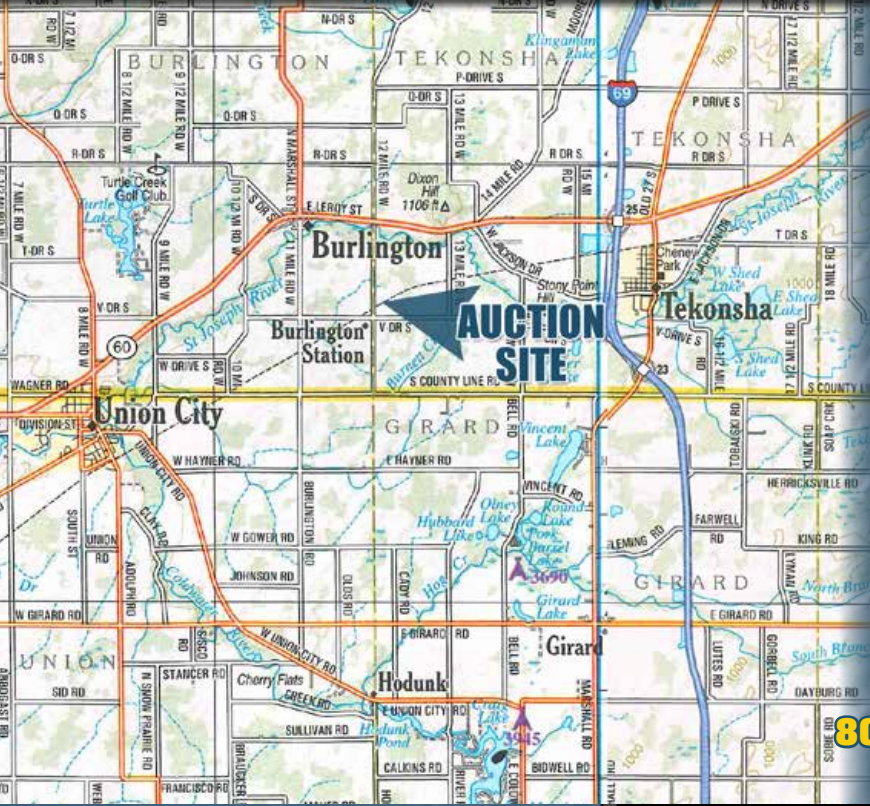

LIVE INTERNET BIDDING
 Visit SchraderAuction.com for Details
 or call Arden Schrader 800-451-2709

SCHRADER
 Real Estate and Auction Company, Inc.

800-451-2709 • SchraderAuction.com • equipment.schraderauction.com

SCHRADER
 Real Estate and Auction Company, Inc.

CORPORATE HEADQUARTERS:
 950 N. Liberty Dr.,
 Columbia City, IN 46725

**AUCTION
 MANAGER:
 ARDEN SCHRADER
 260-229-2442**

Schrader Real Estate and Auction Company Inc.,
 6505397356



DECEMBER 2025						
SUN	MON	TUE	WED	THU	FRI	SAT
	1	2	3	4	5	6
7	8	9	10	11	12	13
14	15	16	17	18	19	20
21	22	23	24	25	26	27
28	29	30	31			

TERMS: Cash or Check w/proper ID. 3% surcharge fee for credit cards.
 Announcements made the day of the auction take precedence over
 any printed material. Not responsible for accidents.
 *2.5% Buyer's Premium capped at \$750.00 added to all winning bids.
 *All items are sold "AS IS", without any warranty of any kind.
 *Payment is due by the end of the 2nd business day after the auction.
LUNCH AVAILABLE

800-451-2709
SchraderAuction.com
equipment.schraderauction.com

Groholski Farms.
**farm equipment
 AUCTION**

Calhoun County, MI



Tuesday, December 9th • 10:30am

Calhoun County, MI

1230 12 mile Rd,
 Burlington, MI 49029

- TRACTORS • SEMI TRACTORS
- TRAILERS • TRUCKS
- SPRAYER • PLANTERS
- 28% APPLICATOR
- TILLAGE EQUIPMENT
- CARTS • GRAIN VAC
- EXCAVATOR
- TILE EQUIPMENT
- WAGONS
- TANKS • SKID LOADER
- MILLING MACHINE • LATHE
- IRRIGATION SUPPLIES
- VARIOUS FARM RELATED ITEMS

LIVE INTERNET BIDDING
 Visit SchraderAuction.com for Details
 or call Arden Schrader 800-451-2709

Groholski Farms.
**farm equipment
 AUCTION**



**THE ORIGINAL MULTI-TRACT
 AUCTIONS**

800-451-2709 • SchraderAuction.com • equipment.schraderauction.com

Groholski Farms farm equipment AUCTION

Calhoun County, MI

Tuesday, December 9th • 10:30am



LOCATED: 1230 12 mile Rd, Burlington, MI 49029.
From the intersection of I-69 and SR 60 go West on Michigan SR 60 approx 3 1/2 miles to 12 Mile Rd then South to the auction.

• **TRACTORS • SEMI TRACTORS • HOPPER BOTTOM TRAILERS**
• **NURSE TRUCK • DUMP TRUCK • STORAGE TRAILERS • DETACH TRAILER • TANKER TRAILERS**

- 2002 John Deere 9520T tractor, 30" tracs, powershift, quick hitch, pto, 4 remotes, power beyond, 26 front weights, 7370 hrs
- 2005 John Deere 8520T tractor, 24" tracs, (10 hrs ago), powershift, quick hitch, pto, 5 remotes, 22 front weights, 10 mid rack weights, 8 idler wheel weights, 5994 hrs
- 1998 John Deere 9200 4WD tractor, quad, 480/80R42 hub duals, 3pt, pto, 3 remotes, 5196 hrs
- 1995 John Deere 8100 MFWD tractor, powershift, 480/80R42 hub duals, 380/85-30 front duals, fenders, 3pt, pto, 5 remotes, 10 front weights, 5509 total hrs, shows 465 hrs
- John Deere 6320L tractor, quad, open station, canopy, 460/70R24 Michelin tires, quick hitch, pto, 2 remotes, 5188 hrs
- 1970 John Deere 4020 diesel tractor, WF, synchro, 18.4-34 tires, console, quick hitch, pto, 1 remote, starter pad & 2 front weights, 7265 hrs
- Allis Chalmers WD45 tractor, gas, NE, 13.6-28 tires, belt pulley
- 2008 Agri Trader 34' tri-axle hopper bottom trailer, SS, 72" sides, SS hoppers, air ride, 102" wide, 11R22.5 tires, roll tarp
- 1996 Agri Trader 32' steel hopper bottom trailer, 72" sides, SS hoppers, front & back, 102" wide, 295/75R22.5 tires, alum rims, power roll tarp
- 1980 Agri Trader 32' steel hopper bottom trailer, 72" sides, 96" wide, roll tarp
- 2007 Volvo day cab semi, D13 Detroit, 10sp, air ride, 295/75R22.5 tires, alum rims
- 1990 Volvo day cab semi, Cummins M-11, 9sp, 11R22.5 tires, alum rims
- 1988 Ford Aero Max L9000 day cab semi, Cat, 9sp, 285/75R24.5 tires
- 1996 Ford L8000 tandem truck, Cummins 350, automatic, 2600 gal poly nurse tank, chemical inductor, Transfer pump, load or unload
- 1978 International F2674 tandem dump truck, Cummins 450, 13sp, 11R22.5 tires, 15' Fruehauf alum dump bed
- Tri-axle detach trailer, tandem lowboy, 21' well
- 1976 6500 gal SS tanker, Honda motor, needs new valves
- 4000 gal SS milk tanker, used for water, (no known leaks)
- 20' tandem axle steel trailer, beaver tail, ramps, pintle hitch, No Title
- 18'x8' single axle dual wheel trailer, tilt deck, 2 5/16, No Title
- Strick 53' alum storage trailer • Budd 53' fiberglass storage trailer
- **SPRAYER • PLANTERS • 28% APPLICATOR • TILL BAR • VT TOOL**
• **SOIL FINISHER • DISC CHISEL • SEED RUNNER • SS ONBOARD TANKS • NURSE TRAILERS • CART**

- 2000 Willmar 8400 4WD Sprayer, 1000 gal SS tank, 14.9R46 tires, 120' 5 sec boom, Trimble Light Bar, Midland rate control, 3425 hrs
- 36x20 Kinze 3700 planter, no-till, pneumatic down pressure, Ag Leader row control, corn & bean units, monitor
- 24x30 Flexicoil 9000 frame, Kinze no-till units, Precision vacuum, drives and down pressure, seed firmers w/pop-up fert, variable rate, Precision monitor, Dosatron chemical unit
- (2) Kinze male row planter units
- 2019 24x30 Blue-Jet AT 4610 28% applicator, 1600 gal, 380/90R46 tires, 3" fill, Y drops, Raven 440 variable rate monitor, approx. 2500 acres
- 16x30 Hinker 6000 strip till bar, 380/95-38 tires, 1000 gal tank, heavy duty springs
- 29.6' Speedtiller by K-line Agriculture, vertical tillage tool, 700/50-22.5 tires, hyd basket, 1500 acres on blades
- 30' John Deere 726 soil finisher, walking axles wing & main, 5 bar tine harrow, rear hitch & hyd
- 17 shank John Deere disc chisel, walking axle wings & main, hyd fold
- Unverferth 3750 Seed Runner seed tender, tri-axle, 2 comp, roll tarp, Digi-Star scales, Honda GX 340 motor, corded remote
- (2) 250 gal SS on board saddle tanks for JD 8520T
- 250 gal Top Air saddle tanks, hyd pump
- 1200 gal Duo Lift tandem nurse trailer, chemical inductor, gas motor & pump
- 500 gal tandem nurse trailer, shuttle platform, gas motor & pump
- 500 gal JD pull between, poly tank
- Flexicoil 1740 commodity card, 23.1-26 tires, fill auger
- Hinker 6000 ST cover crop seeder/strip till

• **GRAIN CARTS • GRAIN VAC • TUBE CONVEYOR • EXCAVATOR**
• **TILE PLOW • TILE CART & TRAILER • BOX BLADE • GENERATORS/ WELDER • PROPANE WAGON • GRAVITY & FLAT RACK WAGONS**

- J&M 1150 Grain Storm grain cart, Storm Tracker tracks, 22" auger, hyd spout, scales, roll tarp, spout & rear cameras
- Brent 976 gain cart, 35.5L-32 tires, 16" auger, roll tarp, scales
- Walinga 5614-88 Agri-Vac grain vac system
- 30'x10' Hutchinson tube conveyor, transport, hyd drive
- Hitachi EX 200 LC excavator, 30" tracks, hyd thumb, 49" bucket
- Soil Max Gold Digger Pro tile plow, pull type, 14L-16.1 tires, 4"x6" boots, Trimble controls



INSPECTION DAY:
Thursday, December 4th • 9am to 3pm

- Tile cart w/partial roll of 4" plastic, elec hyd control
- 6 spool tile trailer
- 10' Industrias America 10F box blade
- Generac 25/50 KW pto generator, Century Fire

Star 250 amp AC-DC welder, on trailer

- 1000 gal propane tank on 5th wheel gear
- 15' H&S tandem forage wagon, galvanized, triple beater, used for fines
- John Deere 1210A grain cart
- Flat rack wagon w/JD 1065 gear • Flat rack wagon w/gear
- John Deere 1065A running gear • M&W Little Red Wagon gravity wagon
- Small gravity wagon
- **CONCRETE TRUCK SCALES • 6000, 5000, 2500 GAL POLY TANKS**
• **TRANSFER PUMPS • DIESEL TANK • BLADE • SKID LOADER & LOADER ATTACHMENTS • QUICK HITCHES**

- 70' truck scales, concrete deck, GSE 500 digital read out & printer • (5) ACE 6000 gal poly tanks (inside) • ACE 5500 gal poly tank (inside) • (2) ACE 2500 gal poly tanks (inside) • 1250 gal cone bottom poly tank (inside) • 800 gal poly tank (inside) • (2) ACE 6000 gal poly tanks • ACE 5000 gal poly tank • ACE 3000 gal poly tank • (2) 2500 gal cone bottom poly tanks • (2) Snyder 1200 gal poly tanks • NEW Honda GX 390 Banjo 3" transfer pump, elec start • Honda GX 160 Pace transfer pump • 60 gal & (2) 40 gal chemical inductors • 8000 gal MS diesel fuel tank, concrete saddles • 14' Leon belly mount dozer blade • Miller Pro 75 SS hydro stump grinder, skid loader mount • Skid loader pallet forks • 7' material bucket for JD loader • HD pallet forks for JD loader or 3pt • (2) JD heavy duty quick hitches • (2) JD CAT II quick hitches • MM & White quick hitches • 5' County Line 3pt roto-tiller • 6' County Line landscape rake

• **MILLING MACHINE • TOOLING • METAL LATHE • GRINDER**
• **IRRIGATION PUMP • IRRIGATION SUPPLIES • O-TURN MOWER**
• **SWEEPER • PLANTER PARTS • NUMEROUS GATES • VARIOUS FARM RELATED ITEMS • TIRES & RIMS**

- Rutland Turret Milling Machine, 42"x19" table, digital readout, 3ph • Collets, mills, grinders, shapers, end mills • Le Blond metal lathe, 66" bed, 10" swing, digital readout, 3ph • Harig Super 612 grinder, magnetized bed, cabinet storage base, 3ph • Gorman Rupp pto irrigation pump, 8" in, 6" out • New irrigation river pan • New irrigation rotary screen • (4) Milroy irrigation injection pumps • Comet 1" irrigation gun • (2) small irrigation end guns • 8"x6" irrigation gate valves • 6"x8" suction pipe screen w/check valves • John Blue ground drive pump & wheel • Deines Magnum 2000 O-Turn mower, 20 hp gas, 72" cut, 833 hrs • Deines 48" sweeper attachment • 8" roll solid plastic tile • 4", 6", & 8" plastic tile fittings • (6) JD seed boxes w/finger pickup units • JD & Kinze planter parts • (35) Flexicoil FSO fert/seed units • Flexicoil & Kinze seed units • Kinze seed tubes • (22) Blue Jet no-till 28% coulters & brackets • (16) JD herbicide sprayer • Herbicide banding kit • JD knock on shovels • Plow parts • Red Ball parts • Mid Tech 6100 controller • (2) New Raven direct injection for sprayers • Sure Fire pop up 150 gal tank w/pump • 200 gal pop up poly tank • (2) BASF Dosatron chemical units • Kleenair grain cleaner • Gandy seeder • Bulk seed chute for Pro boxes • 1800 bu cone bottom storage tank, 25' grain leg, (rough) • (3) 17' SS gates • (2) 12' SS gates • (24) 18' steel gates (various conditions) • (16) 12' coral panels • 12' steel gate • 16' cattle panels • Small livestock loading chute • New Mirrofont cattle waterers • (2) used Mirrofont cattle waterers • (2) Smidley creep/sow feeders • New roll woven wire fence • New roll barb wire • Elec fence posts, fence supplies, poly wire, steel wire • 15 hp aeration fan • Voltmaster 15/12 pto generator • (10) JD weights & weight bracket • JD MFWD poly fenders • Front tractor fenders • Assorted heavy duty hyd cylinders • Assorted pto shafts • JD poly grain head snouts • New Banjo 2" transfer pump & B&S engine • Portable 200 gal fuel tank, 12 volt pump • Alum truck fuel tank • (8) 100 lb LP tanks • Ford 700 truck hood • Ford F-450 sleeper cab • Pto hyd pump • Truck fenders & mud flaps • Assorted truck parts • Holland 5th wheel trailer hitch • Truck bumper w/shock hitch • Portable manlift w/outriggers, CO2 powered • 14'x32" incline conveyor on transport • 3" Honda trash pump • Chemical shuttle pumps • (2) 25 hp elec motors • Scale heads for feed grinders • Poly trailer liner, 57" wide • Poly hay tarp, approx 49'x60' • 16'x24' Bifold garage door • 24' single axle trailer frame • 4'x8' single axle trailer • 4 1/2'x7' single axle tilt bed trailer • Branick air bumper jack • Trailer stabilizing pedestal ratchet jack • Portable dual wheel jack • Craftsman radial arm saw • (3) double sided locker units • Pony cart • Used 18" tracs from JD 8520T • 480/80R42 tire & tube • (4) 14.9R46 tires • (2) 14.9R30 tires • 13.6R24 tires & rims • (10) 425/65R 22.5 tires & rims • (3) 295/75R 22.5 tires & rims • 11R 22.5 tire & rim • (2) 11.00-22 tires • (6) 10.00-20 tires • 8.25-20 tires & rims • (2) 16.5-16.1 tires & rims • 12.5L-16 tire & rim • (4) 11L-15 tires & rims • (2) 205/75R14 tires & rims



OWNERS: Groholski Farms / Ed 517-617-3111
Auction Manager: Arden Schrader 260-229-2442

SCHRADER
Real Estate and Auction Company, Inc.

LIVE INTERNET BIDDING
Visit SchraderAuction.com for Details
or call Arden Schrader 800-451-2709

800-451-2709 • SchraderAuction.com • equipment.schraderauction.com