

Soils Map

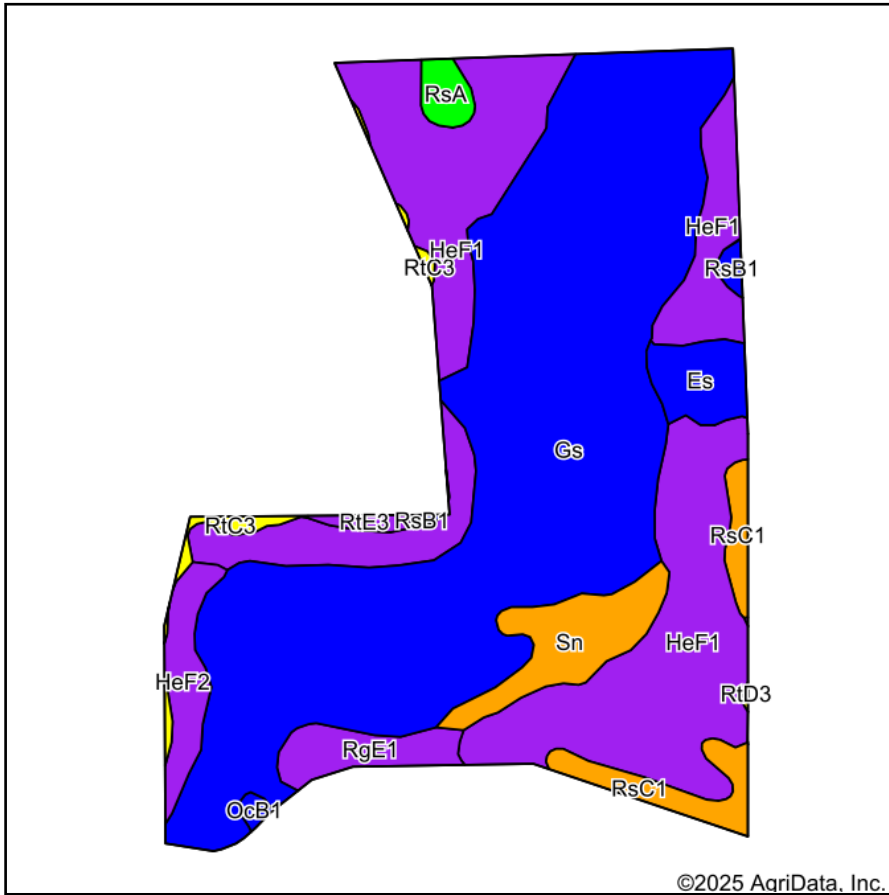

Soils data provided by USDA and NRCS.

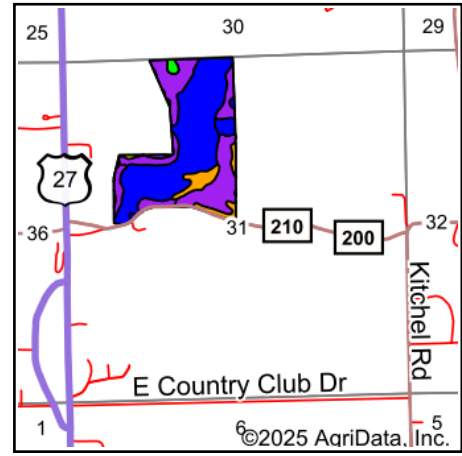

State: **Indiana**
 County: **Union**
 Location: **31-12N-1W**
 Township: **Harrison**
 Acres: **72.6**
 Date: **12/16/2025**



Maps Provided By:

 CUSTOMIZED ONLINE MAPPING
 © AgriData, Inc. 2025 www.AgriDataInc.com



Area Symbol: IN161, Soil Area Version: 26

Code	Soil Description	Acres	Percent of field	Non-Irr Class Legend	Non-Irr Class	Corn Bu	Grass legume hay Tons	Pasture AUM	Soybeans Bu	Winter wheat Bu
Gs	Genesee silt loam, 0 to 2 percent slopes, frequently flooded, brief duration	37.38	51.5%		IIw	121		1	42	3
HeF1	Hennepin loam, 25 to 35 percent slopes, slightly eroded	22.80	31.4%		VIIe					
Sn	Sloan silt loam	2.99	4.1%		IIIw	150			40	
RSC1	Russell silt loam, 6 to 12 percent slopes, slightly eroded	2.19	3.0%		IIIe	145	5	10	51	73
HeF2	Hennepin loam, 25 to 35 percent slopes, moderately eroded	1.81	2.5%		VIIe					
RgE1	Rodman gravelly loam, 18 to 25 percent slopes, slightly eroded	1.69	2.3%		VIIe	20	1	1	7	10
Es	Eel silt loam, 0 to 2 percent slopes, frequently flooded	1.66	2.3%		IIw	127	4	8	44	18
RsA	Russell silt loam, 0 to 2 percent slopes	0.69	1.0%		I	155	5	10	54	78
RtC3	Russell soils, 6 to 12 percent slopes, severely eroded	0.62	0.9%		IVe	135	5	9	47	68
RtE3	Russell soils, 18 to 25 percent slopes, severely eroded	0.30	0.4%		VIe	105	4	7	37	53
RSB1	Russell silt loam, 2 to 6 percent slopes	0.29	0.4%		Ile	156	5	10	54	69
OcB1	Ockley silt loam, 2 to 6 percent slopes, slightly eroded	0.18	0.2%		Ile	135	5	9	47	68
Weighted Average					3.91	80.2	0.4	1.3	27.4	6.4

Soils data provided by USDA and NRCS.