

Soils Map

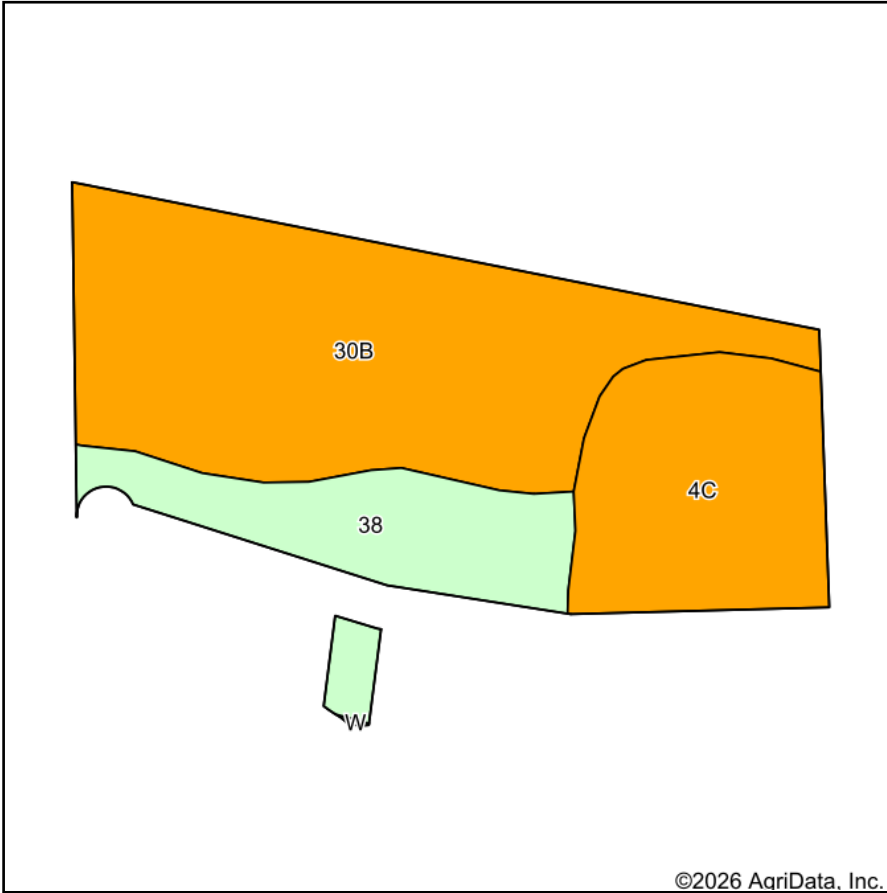

Soils data provided by USDA and NRCS.

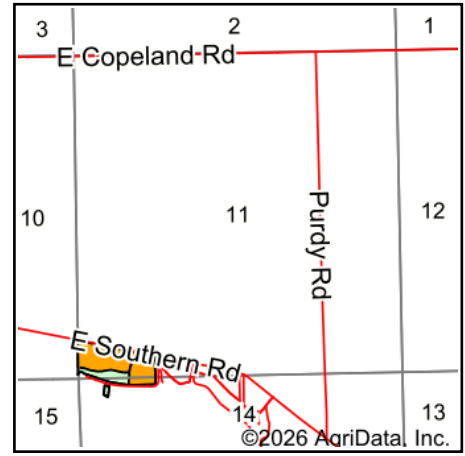

State: **Michigan**
 County: **Branch**
 Location: **11-8S-6W**
 Township: **Kinderhook**
 Acres: **16.2**
 Date: **6/25/2026**



Area Symbol: MI023, Soil Area Version: 23

Code	Soil Description	Acres	Percent of field	Non-Irr Class Legend	Non-Irr Class	Irr Class	Corn Bu	Corn Irrigated Bu	Corn silage Tons	Corn silage Irrigated Tons	Oats Bu	Soybeans Bu	Winter wheat Bu	Winter wheat Irrigated Bu
30B	Leoni gravelly sandy loam, 0 to 6 percent slopes	9.07	56.0%		Ills	Ills	115	150	19	25	95	35	50	55
4C	Oshtemo sandy loam, 6 to 12 percent slopes	4.04	24.9%		Ille	Ille								
38	Udipsamments, gently sloping	3.09	19.1%											
Weighted Average					*-	*-	64.4	84	10.6	14	53.2	19.6	28	30.8

*- Non Irr Class weighted average cannot be calculated on the current soils data due to missing data.

*- Irr Class weighted average cannot be calculated on the current soils data due to missing data.

Soils data provided by USDA and NRCS.